

Compat[®] Adapter

COMPAT[®] ADAPTER ENFit[™] SET → US FUNNEL TUBE

تعليمات الاستخدام / Instructions for Use / Instruções de utilização

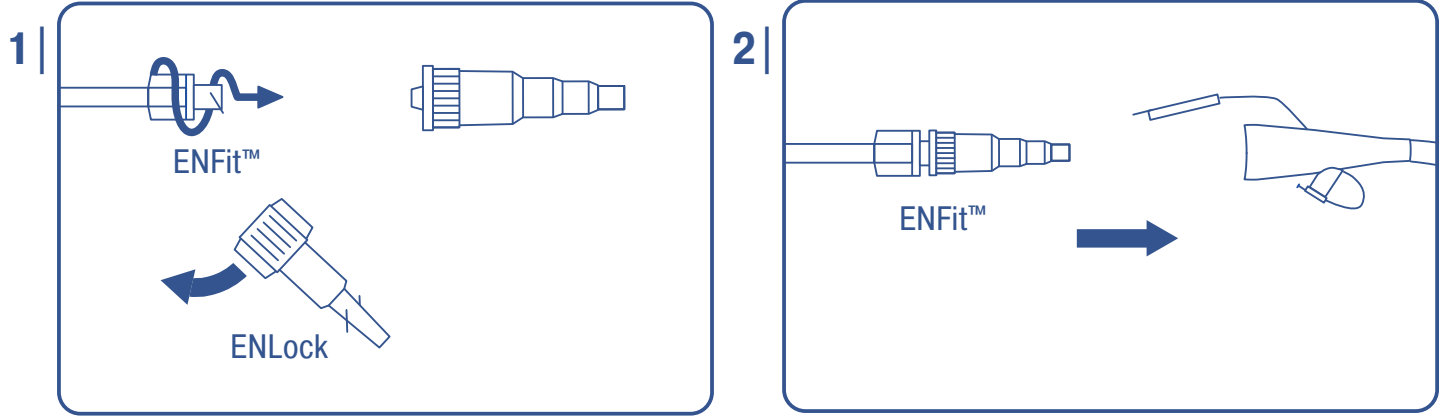

AR وحدة التوصيل الخاصة بين جزء ال ENFit[™] وبين أنابيب التغذية مع المنافذ القمعية. خالية من DEHP. مدة الاستعمال: لا تستعملها لأكثر من ٢٤ ساعة. ملاحظة هامة: للاستعمال المعوي فقط. Ⓢ غير مخصصة للاستعمال عن طريق الوريد. Ⓢ لا تستعملها في حال تلف العبوة. يرجى العلم بأنه: قد يتغير أداء الجهاز بعد الاستعمال ومن الممكن أن يصبح مصدرا للعدوى. اتبع الممارسات الصحية الجيدة وقم باعتماد اللوائح المحلية والعالمية في حالة النقل أو في حال الاتلاف. في حالة عدم استعمال الجهاز بالشكل الموصى به فقد تتسبب الاجزاء الصغيرة بخطر الاختناق. يستعمل باشراف شخص بالغ.

EN Adapter for connecting ENFit[™] administration sets to feeding tubes with legacy funnel ports. DEHP-free. Duration of Use: Do not use for more than 24 hours. Important Notes: For enteral use only. Ⓢ Not for intravenous use. Ⓢ Do not use if package is damaged. Please Note: The device may become a source of infection and have altered performance after use. Follow good clinical practice and all local and national regulations for transportation and disposal. Small parts are a potential choking hazard if this device is not used as intended. Use under adult supervision.

PT Adaptador para sistemas de administração ENFit[™] para conectar as sondas de alimentação preexistentes. Não contém DEHP. Prazo de utilização: Não usar mais do que 24 horas. Notas importantes: Apenas para uso enteral. Ⓢ Não utilizar por via parenteral. Ⓢ Não utilizar se a embalagem estiver violada. Atenção: Depois de utilizado, o dispositivo pode tornar-se uma fonte de infecção e alterar o seu correto funcionamento. Siga as boas práticas clínicas recomendadas bem como os regulamentos locais e nacionais em matéria de transporte e eliminação. Pequenas peças são um potencial perigo para asfixia, caso este dispositivo não seja usado adequadamente. Utilizar sob supervisão de um adulto.

 REF 12298016



AU
Nestlé HealthCare Nutrition
20-24 Howleys Road
Notting Hill VIC 3168
Australia
1800 671 628

BR
Nestlé Brasil Ltda,
CNPJ 60.409.075/0100-34
Estrada dos Alvarengas
630 São Bernardo do Campo,
São Paulo - SP Brazil
Serviço Nestlé ao
consumidor: 0800-7702461

HK
Nestlé Healthcare Nutrition
7/F Manhattan Place
23 Wang Tai Road
Kowloon Bay
Kowloon
Hong Kong
Tel: (852) 8202 9876

ME
Nestlé Middle East FZE
Inside UAE and KSA
800 8-971971 (free line)
Other countries
+9714-8100 000
P.O. BOX 17327
JEBEL ALI FREE ZONE
DUBAI – UNITED ARAB EMIRATES

NZ
Nestlé HealthCare Nutrition
12-16 Nicholls Lane
Parnell Auckland
New Zealand
0800 607 662

SG
Nestlé Singapore (Pte) Ltd
15A Changi Business Park Central 1
#05-02 Eigthrium @ Changi
Business Park
Singapore 486035
Customer Service
Tel: 1800-836-7009

C 00749 29JAN2016 508204





Via Liberazione 63/9, 20068 Peschiera Borromeo (MI), Italy

Unless stated otherwise, all trademarks are owned by Société des Produits Nestlé S.A. or used with permissions.

www.compat.com